

DANLY

# DANFLEX

Urethane springs and other products





# Springs for medium load

Hardness: 80 Shore A

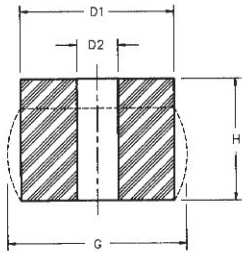

COLOUR CODE: BLUE

D1	D2	H	CATALOGUE REFERENCE	LOAD - DEFLECTION TABLE								
				Long Life (25 %)			Medium Life (30 %)			Max. Deflection (35 %)		
				Load da N	Deflection mm	G mm	Load da N	Deflection mm	G mm	Load da N	Deflection mm	G mm
16	6,5	12 16 20 25	OU-016012-80 OU-016016-80 OU-016020-80 OU-016025-80	48 46 46 43	3,3 4,0 5,0 6,3	20	70 65 62 59	3,9 4,8 6,0 7,5	21	94 90 88 86	4,6 5,6 7,0 8,8	22
20	8,5	16 20 25 32	OU-020016-80 OU-020020-80 OU-020025-80 OU-020032-80	78 73 69 66	4,0 5,0 6,3 8,0	25	102 95 93 87	4,8 6,0 7,5 9,6	26	140 135 133 128	5,6 7,0 8,8 11,2	27
25	10,5	20 25 32 40	OU-025020-80 OU-025025-80 OU-025032-80 OU-025040-80	113 111 110 108	5,0 6,3 8,0 10,0	31	150 148 146 143	6,0 7,5 9,6 12,0	33	220 216 209 205	7,0 8,8 11,2 14,0	34
32	13,5	32 40 50 63	OU-032032-80 OU-032040-80 OU-032050-80 OU-032063-80	180 178 167 162	8,0 10,0 12,5 15,8	40	242 240 230 220	9,6 12,0 15,0 18,9	42	346 342 335 324	11,2 14,0 18,0 22,0	43
40	13,5	32 40 50 63 80	OU-040032-80 OU-040040-80 OU-040050-80 OU-040063-80 OU-040080-80	320 310 305 280 270	8,0 10,0 12,5 15,8 20,0	50	450 420 400 380 370	9,6 12,0 15,0 18,9 24,0	52	619 601 587 576 554	11,2 14,0 18,0 22,0 28,0	54
50	17	32 40 50 63 80 100	OU-050032-80 OU-050040-80 OU-050050-80 OU-050063-80 OU-050080-80 OU-050100-80	520 490 480 470 465 460	8,0 10,0 12,5 15,8 20,0 25,0	62	700 640 635 630 625 620	9,6 12,0 15,0 18,9 24,0 30,0	65	997 965 940 914 898 864	11,2 14,0 18,0 22,0 28,0 35,0	68
63	17	32 40 50 63 80 100 125	OU-063032-80 OU-063040-80 OU-063050-80 OU-063063-80 OU-063080-80 OU-063100-80 OU-063125-80	980 830 820 815 780 770 750	8,0 10,0 12,5 15,8 20,0 25,0 31,3	78	1200 1150 1100 1070 1050 1030 1000	9,6 12,0 15,0 18,9 24,0 30,0 37,5	82	1760 1688 1631 1577 1526 1494 1467	11,2 14,0 18,0 22,0 28,0 35,0 43,8	85
80	21	32 40 50 63 80 100 125	OU-080032-80 OU-080040-80 OU-080050-80 OU-080063-80 OU-080080-80 OU-080100-80 OU-080125-80	1650 1550 1500 1400 1350 1300 1250	8,0 10,0 12,5 15,8 20,0 25,0 31,3	99	2400 2000 1900 1850 1800 1750 1700	9,6 12,0 15,0 18,9 24,0 30,0 37,5	104	2920 2869 2750 2642 2556 2481 2419	11,2 14,0 18,0 22,0 28,0 35,0 43,8	108
100	21	32 40 50 63 80 100 125	OU-100032-80 OU-100040-80 OU-100050-80 OU-100063-80 OU-100080-80 OU-100100-80 OU-100125-80	2800 2500 2400 2300 2250 2200 2100	8,0 10,0 12,5 15,8 20,0 25,0 31,3	124	3500 3300 3250 3200 3150 2850 2800	9,6 12,0 15,0 18,9 24,0 30,0 37,5	130	4960 4800 4673 4457 4277 4154 3996	11,2 14,0 18,0 22,0 28,0 35,0 43,8	135
125	27	32 40 50 63 80 100 125 160	OU-125032-80 OU-125040-80 OU-125050-80 OU-125063-80 OU-125080-80 OU-125100-80 OU-125125-80 OU-125160-80	4800 4500 4100 3900 3700 3550 3300 3250	8,0 10,0 12,5 15,8 20,0 25,0 31,3 37,5	155	5600 5500 5300 5100 5000 4800 4700 4300	9,6 12,0 15,0 18,9 24,0 30,0 37,5 45,0	163	8900 8400 7900 7395 6948 6610 6476 5500	11,2 14,0 18,0 22,0 28,0 35,0 43,8 52,5	169

# Springs for heavy load

Hardness: 90 Shore A

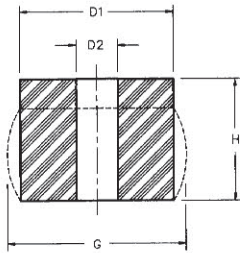

COLOUR CODE: RED

D1	D2	H	CATALOGUE REFERENCE	LOAD - DEFLECTION TABLE								
				Long Life (20 %)			Medium Life (25 %)			Max. Deflection (30 %)		
				Load da N	Deflection mm	G mm	Load da N	Deflection mm	G mm	Load da N	Deflection mm	G mm
16	6,5	12	OU-016012-90	102	2,6	19	128	3,3	20	178	3,9	21
		16	OU-016016-90	90	3,2		122	4,0		173	4,8	
		20	OU-016020-90	88	4,0		120	5,0		169	6,0	
		25	OU-016025-90	86	5,0		117	6,3		166	7,5	
20	8,5	16	OU-020016-90	136	3,2	24	185	4,0	25	269	4,8	26
		20	OU-020020-90	134	4,0		182	5,0		259	6,0	
		25	OU-020025-90	132	5,0		180	6,3		255	7,5	
		32	OU-020032-90	128	6,4		178	8,0		245	9,6	
25	10,5	20	OU-025020-90	220	4,0	30	300	5,0	31	421	6,0	33
		25	OU-025025-90	217	5,0		285	6,3		414	7,5	
		32	OU-025032-90	212	6,4		278	8,0		400	9,6	
		40	OU-025040-90	208	8,0		276	10,0		393	12,0	
32	13,5	32	OU-032032-90	340	6,4	39	465	8,0	40	662	9,6	42
		40	OU-032040-90	330	8,0		460	10,0		656	12,0	
		50	OU-032050-90	325	10,0		450	12,5		642	15,0	
		63	OU-032063-90	310	12,5		440	15,8		621	18,9	
40	13,5	32	OU-040032-90	630	6,4	48	830	8,0	50	1187	9,6	52
		40	OU-040040-90	605	8,0		820	10,0		1152	12,0	
		50	OU-040050-90	595	10,0		800	12,5		1125	15,0	
		63	OU-040063-90	580	12,5		790	15,8		1104	18,9	
50	17	80	OU-040080-90	570	16,0	60	780	20,0	62	1063	24,0	65
		32	OU-050032-90	1000	6,4		1350	8,0		1911	9,6	
		40	OU-050040-90	990	8,0		1310	10,0		1849	12,0	
		50	OU-050050-90	950	10,0		1250	12,5		1801	15,0	
63	17	63	OU-050063-90	930	12,5	75	1240	15,8	78	1753	18,9	82
		80	OU-050080-90	910	16,0		1230	20,0		1722	24,0	
		100	OU-050100-90	900	20,0		1210	25,0		1656	30,0	
		32	OU-063032-90	1680	6,4		2300	8,0		3374	9,6	
80	21	40	OU-063040-90	1660	8,0	95	2250	10,0	99	3236	12,0	104
		50	OU-063050-90	1630	10,0		2200	12,5		3126	15,0	
		63	OU-063063-90	1600	12,5		2150	15,8		3022	18,9	
		80	OU-063080-90	1500	16,0		2100	20,0		2926	24,0	
100	21	100	OU-063100-90	1480	20,0	119	1950	25,0	124	2864	30,0	130
		125	OU-063125-90	1460	25,0		1900	31,3		2812	37,5	
		32	OU-080032-90	3500	6,4		4200	8,0		5750	9,6	
		40	OU-080040-90	3300	8,0		4000	10,0		5500	12,0	
125	27	50	OU-080050-90	2700	10,0	149	3800	12,5	155	5272	15,0	163
		63	OU-080063-90	2600	12,5		3600	15,8		5065	18,9	
		80	OU-080080-90	2550	16,0		3500	20,0		4900	24,0	
		100	OU-080100-90	2520	20,0		3450	25,0		4775	30,0	
160	27	125	OU-080125-90	2490	25,0	199	3300	31,3	204	4637	37,5	210
		32	OU-100032-90	5500	6,4		7800	8,0		9942	9,6	
		40	OU-100040-90	5200	8,0		7100	10,0		9527	12,0	
		50	OU-100050-90	4800	10,0		6500	12,5		8956	15,0	
160	27	63	OU-100063-90	4500	12,5	249	6200	15,8	254	8542	18,9	260
		80	OU-100080-90	4300	16,0		5800	20,0		8197	24,0	
		100	OU-100100-90	4250	20,0		5700	25,0		7963	30,0	
		125	OU-100125-90	4200	25,0		5600	31,3		7659	37,5	
160	27	32	OU-125032-90	11000	6,4	349	14000	8,0	354	16875	9,6	360
		40	OU-125040-90	10000	8,0		13000	10,0		16367	12,0	
		50	OU-125050-90	9000	10,0		11000	12,5		15223	15,0	
		63	OU-125063-90	7500	12,5		10500	15,8		14163	18,9	
160	27	80	OU-125080-90	7200	16,0	449	10000	20,0	454	13317	24,0	460
		100	OU-125100-90	6750	20,0		9100	25,0		12668	30,0	
		125	OU-125125-90	6600	25,0		8600	31,3		12413	37,5	
		160	OU-125160-90	6200	30,0		8400	37,5		11937	45,0	

# Springs for extra heavy load

Hardness: 95 Shore A

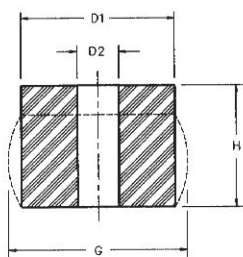

COLOUR CODE: YELLOW

D1	D2	H	CATALOGUE REFERENCE	LOAD - DEFLECTION TABLE								
				Long Life (15 %)			Medium Life (20 %)			Max. Deflection (25 %)		
				Load da N	Deflection mm	G mm	Load da N	Deflection mm	G mm	Load da N	Deflection mm	G mm
16	6,5	12 16 20 25	OU-016012-95 OU-016016-95 OU-016020-95 OU-016025-95	102 99 97 95	2,0 2,4 3,0 3,8	18	158 142 141 136	2,6 3,2 4,0 5,0	19	222 217 213 208	3,3 4,0 5,0 6,3	20
20	8,5	16 20 25 32	OU-020016-95 OU-020020-95 OU-020025-95 OU-020032-95	155 150 145 142	2,4 3,0 3,8 4,8	23	220 215 208 203	3,2 4,0 5,0 6,4	24	339 326 321 308	4,0 5,0 6,3 8,0	25
25	10,5	20 25 32 40	OU-025020-95 OU-025025-95 OU-025032-95 OU-025040-95	240 235 230 225	3,0 3,8 4,8 6,0	29	350 345 340 330	4,0 5,0 6,4 8,0	30	529 521 503 495	5,0 6,3 8,0 10,0	31
32	13,5	32 40 50 63	OU-032032-95 OU-032040-95 OU-032050-95 OU-032063-95	380 375 370 355	4,8 6,0 7,5 9,5	37	570 550 530 510	6,4 8,0 10,0 12,5	39	833 825 807 781	8,0 10,0 12,5 15,8	40
40	13,5	32 40 50 63 80	OU-040032-95 OU-040040-95 OU-040050-95 OU-040063-95 OU-040080-95	700 660 630 620 600	4,8 6,0 7,5 9,5 12,0	46	970 960 950 910 880	6,4 8,0 10,0 12,5 16,0	48	1493 1450 1415 1389 1337	8,0 10,0 12,5 15,8 20,0	50
50	17	32 40 50 63 80 100	OU-050032-95 OU-050040-95 OU-050050-95 OU-050063-95 OU-050080-95 OU-050100-95	1100 1060 1050 1040 1020 1010	4,8 6,0 7,5 9,5 12,0 15,0	57	1550 1530 1510 1500 1490 1470	6,4 8,0 10,0 12,5 16,0 20,0	60	2404 2326 2265 2205 2166 2083	8,0 10,0 12,5 15,8 20,0 25,0	62
63	17	32 40 50 63 80 100 125	OU-063032-95 OU-063040-95 OU-063050-95 OU-063063-95 OU-063080-95 OU-063100-95 OU-063125-95	2150 2100 1800 1780 1750 1700 1650	4,8 6,0 7,5 9,5 12,0 15,0 18,8	72	2950 2850 2700 2650 2500 2400 2300	6,4 8,0 10,0 12,5 16,0 20,0 25,0	75	4245 4071 3932 3802 3680 3602 3537	8,0 10,0 12,5 15,8 20,0 25,0 31,3	78
80	21	32 40 50 63 80 100 125	OU-080032-95 OU-080040-95 OU-080050-95 OU-080063-95 OU-080080-95 OU-080100-95 OU-080125-95	3100 3000 2950 2900 2800 2750 2700	4,8 6,0 7,5 9,5 12,0 15,0 18,8	91	4600 4400 4200 4100 4050 4000 3800	6,4 8,0 10,0 12,5 16,0 20,0 25,0	95	7231 6918 6632 6371 6163 6007 5833	8,0 10,0 12,5 15,8 20,0 25,0 31,3	99
100	21	32 40 50 63 80 100 125	OU-100032-95 OU-100040-95 OU-100050-95 OU-100063-95 OU-100080-95 OU-100100-95 OU-100125-95	5700 5500 5300 4800 4700 4600 4500	4,8 6,0 7,5 9,5 12,0 15,0 18,8	114	7600 7400 7200 7100 7000 6800 6500	6,4 8,0 10,0 12,5 16,0 20,0 25,0	119	12879 12035 11267 10746 10312 10017 9635	8,0 10,0 12,5 15,8 20,0 25,0 31,3	124
125	27	32 40 50 63 80 100 125 160	OU-125032-95 OU-125040-95 OU-125050-95 OU-125063-95 OU-125080-95 OU-125100-95 OU-125125-95 OU-125160-95	8900 8500 8300 8000 7800 7500 7300 7200	4,8 6,0 7,5 9,5 12,0 15,0 18,8 22,5	143	14500 13800 13400 12300 11000 10800 10600 10000	6,4 8,0 10,0 12,5 16,0 20,0 25,0 30,0	149	21654 20234 18976 17829 16752 15936 15615 15016	8,0 10,0 12,5 15,8 20,0 25,0 31,3 38,0	155

## Strippers

Hardness: 90 Shore A

CATALOGUE REFERENCE	D1 mm	D2 mm	H mm	B mm
OU-ST0556	18	5	56	1,6
OU-ST0656	19	6	56	1,6
OU-ST0665	19	6	65	1,6
OU-ST0856	21	8	56	1,6
OU-ST0875	21	8	75	1,6
OU-ST1056	23	10	56	2,5
OU-ST1356	26	13	56	3,0
OU-ST1375	26	13	75	3,0
OU-ST1656	30	16	56	3,0
OU-ST1675	30	16	75	3,0
OU-ST2056	38	20	56	3,0
OU-ST2556	50	25	56	3,0
OU-ST3256	63	32	56	3,0
OU-ST3556	65	35	56	3,0
OU-ST5056	80	50	56	3,0

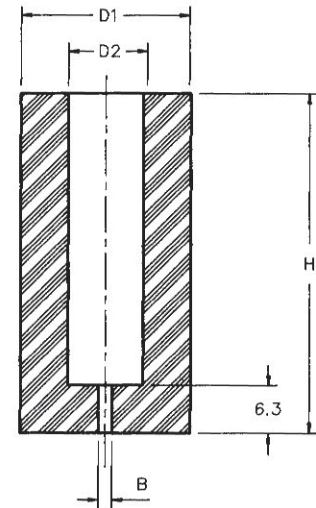

Other hardnesses and lengths available upon request.

## Round Hollow bar

D1 mm	D2 mm	CAT. REF. H = 250 mm	CAT. REF. H = 500 mm	D1 mm	D2 mm	CAT. REF. H = 250 mm	CAT. REF. H = 500 mm
16	6,5	OUHT-016250-XX	OUHT-016500-XX	50	17	OUHT-050250-XX	OUHT-050500-XX
20	8,5	OUHT-020250-XX	OUHT-020500-XX	63	17	OUHT-063250-XX	OUHT-063500-XX
25	10,5	OUHT-025250-XX	OUHT-025500-XX	80	21	OUHT-080250-XX	OUHT-080500-XX
32	13,5	OUHT-032250-XX	OUHT-032500-XX	100	21	OUHT-100250-XX	OUHT-100500-XX
40	13,5	OUHT-040250-XX	OUHT-040500-XX	125	27	OUHT-125250-XX	OUHT-125500-XX

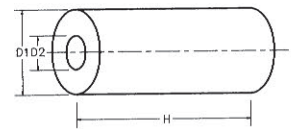

CODE X X	HARDNESS
80	80 SHORE A
90	90 SHORE A
95	95 SHORE A

## Round Solid bar

D	H		D	H		D	H	
	250 mm	500 mm		250 mm	500 mm		250 mm	500 mm
2	•		50	•	•	160	•	•
3	•	•	55	•	•	170	•	
4	•	•	60	•	•	175	•	
5	•	•	63	•	•	180	•	•
6	•	•	65	•	•	190	•	
7	•	•	70	•	•	200	•	•
8	•	•	75	•	•	205	•	
9	•		80	•	•	210	•	
10	•	•	85	•	•	220	•	
11	•	•	90	•	•	225	•	
12	•	•	100	•	•	230	•	
13	•	•	105	•		240	•	
14	•	•	110	•	•	250	•	
15	•	•	115	•		255	•	
16	•	•	120	•	•	260	•	
17	•	•	122	•		270	•	
18	•	•	125	•	•	280	•	
20	•	•	129	•		285	•	
25	•	•	130	•	•	300	•	
30	•	•	135	•		310	•	
32	•	•	140	•	•	320	•	
35	•	•	145	•		330	•	
40	•	•	150	•	•	350	•	
45	•	•	155	•				

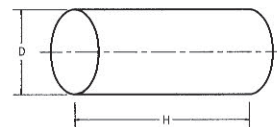

### ORDERING EXAMPLES

Round Solid bar D = 32mm, H = 500mm, 80 SHORE A  
CATALOGUE REFERENCE: **OUPT-0325-80**

Round Solid bar D = 210mm, H = 250mm, 95 SHORE A  
CATALOGUE REFERENCE: **OUPT-2102-95**

Other sizes in Round, Square and Rectangular sections are available upon request.

## Washers for spring stacking

**Material:** Polyamid

Spring stacking reduces bulging, increases the total rate and significantly improves life.

### INTERMEDIATE WASHERS

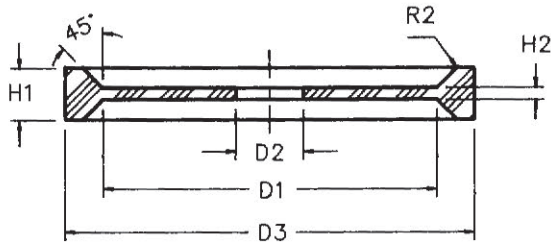

### END WASHERS

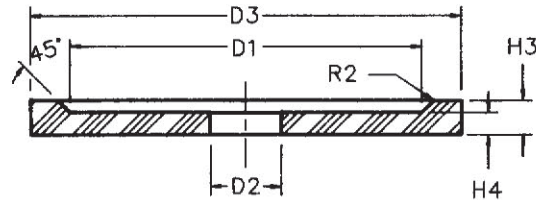

CATALOGUE REFERENCE	D1 ± 0,5 mm	D2 H 11 mm	D3 ± 0,3 mm	H1 ± 0,5 mm	H2 ± 0,5 mm
OU-RIM016	16,5	6,5	24	4,5	1,3
OU-RIM020	20,5	8,5	30	5,6	1,6
OU-RIM025	25,5	10,5	34	6,3	2,0
OU-RIM032	33,0	13,5	45	7,1	2,0
OU-RIM040	41,0	13,5	54	8,0	2,5
OU-RIM050	51,0	16,5	66	10,0	2,5
OU-RIM063	64,0	16,5	80	10,0	3,2
OU-RIM080	82,0	20,5	100	13,0	3,2
OU-RIM100	102,0	20,5	125	16,0	3,6
OU-RIM125	128,0	20,5	150	16,0	3,6

CATALOGUE REFERENCE	D1 ± 0,5 mm	D2 H 11 mm	D3 ± 0,3 mm	H3 ± 0,5 mm	H4 ± 0,5 mm
OU-RIB016	16,5	6,5	24	3,8	1,8
OU-RIB020	20,5	8,5	30	4,2	2,2
OU-RIB025	25,5	10,5	34	4,8	2,4
OU-RIB032	33,0	13,5	45	5,0	2,7
OU-RIB040	41,0	13,5	54	5,8	3,0
OU-RIB050	51,0	16,5	66	6,5	3,5
OU-RIB063	64,0	16,5	80	7,5	4,0
OU-RIB080	82,0	20,5	100	8,5	5,0
OU-RIB100	102,0	20,5	125	10,0	6,5
OU-RIB125	128,0	20,5	150	10,0	6,5

### LOAD MULTIPLICATION FACTORS FOR SPRING STACKING

OUTSIDE DIAMETER	NUMBER OF STACKED SPRINGS		
	2	3	4
16	1,04	-	-
20	1,05	-	-
25	1,06	-	-
32	1,07	-	-
40	1,08	-	-
50	1,09	1,12	-
63	1,10	1,15	1,18
80	1,13	1,17	1,20
100	1,15	1,20	1,23
125	1,18	1,22	1,25

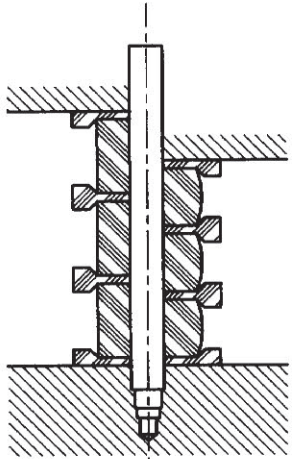

**EXAMPLE:**

A OU-063100-90 spring deflected 25 mm will have a load of 1950 daN.  
 A stacking of 2 OU-06350-90 springs submitted to the same total deflection of 25 mm will have a total load of 1950 x 1,10 = 2145 daN.

# Plates

S mm	CATALOGUE REFERENCE			
	A = 250 mm B = 250 mm	A = 500 mm B = 500 mm	A = 1000 mm B = 500 mm	A = 1000 mm B = 1000 mm
0,5	OU-P1005-XX	-	-	-
1,0	OU-P1010-XX	OU-P3010-XX	OU-P4010-XX	-
1,5	OU-P1015-XX	OU-P3015-XX	OU-P4015-XX	-
2,0	OU-P1020-XX	OU-P3020-XX	OU-P4020-XX	OU-P5020-XX
3,0	OU-P1030-XX	OU-P3030-XX	OU-P4030-XX	OU-P5030-XX
4,0	OU-P1040-XX	OU-P3040-XX	OU-P4040-XX	OU-P5040-XX
5,0	OU-P1050-XX	OU-P3050-XX	OU-P4050-XX	OU-P5050-XX
6,0	OU-P1060-XX	OU-P3060-XX	OU-P4060-XX	OU-P5060-XX
7,0	OU-P1070-XX	OU-P3070-XX	OU-P4070-XX	OU-P5070-XX
8,0	OU-P1080-XX	OU-P3080-XX	OU-P4080-XX	OU-P5080-XX
9,0	OU-P1090-XX	OU-P3090-XX	OU-P4090-XX	OU-P5090-XX
10,0	OU-P1100-XX	OU-P3100-XX	OU-P4100-XX	OU-P5100-XX
12,0	OU-P1120-XX	OU-P3120-XX	OU-P4120-XX	OU-P5120-XX
15,0	OU-P1150-XX	OU-P3150-XX	OU-P4150-XX	OU-P5150-XX
18,0	OU-P1180-XX	OU-P3180-XX	OU-P4180-XX	OU-P5180-XX
20,0	OU-P1200-XX	OU-P3200-XX	OU-P4200-XX	OU-P5200-XX
25,0	OU-P1250-XX	OU-P3250-XX	OU-P4250-XX	OU-P5250-XX
30,0	OU-P1300-XX	OU-P3300-XX	OU-P4300-XX	OU-P5300-XX
35,0	OU-P1350-XX	OU-P3350-XX	OU-P4350-XX	OU-P5350-XX
40,0	OU-P1400-XX	OU-P3400-XX	OU-P4400-XX	OU-P5400-XX
45,0	OU-P1450-XX	OU-P3450-XX	OU-P4450-XX	OU-P5450-XX
50,0	OU-P1500-XX	OU-P3500-XX	OU-P4500-XX	OU-P5500-XX
55,0	OU-P1550-XX	OU-P3550-XX	OU-P4550-XX	OU-P5550-XX
60,0	OU-P1600-XX	OU-P3600-XX	OU-P4600-XX	OU-P5600-XX
65,0	OU-P1650-XX	OU-P3650-XX	OU-P4650-XX	OU-P5650-XX
70,0	OU-P1700-XX	OU-P3700-XX	OU-P4700-XX	OU-P5700-XX
75,0	OU-P1750-XX	OU-P3750-XX	OU-P4750-XX	OU-P5750-XX
80,0	OU-P1800-XX	OU-P3800-XX	OU-P4800-XX	OU-P5800-XX

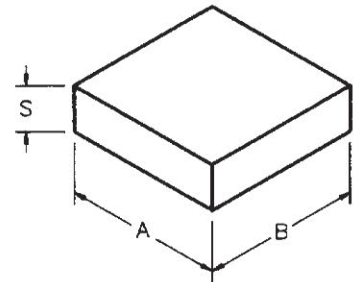

CODE X X	HARDNESS
80	80 SHORE A
90	90 SHORE A
95	95 SHORE A

# Cushions

L mm	TRIANGULAR				RECTANGULAR / SQUARE			
	B mm	PLAIN  CAT. REF.	HOLLOW  CAT. REF.	A mm	B mm	PLAIN  CAT. REF.	HOLLOW  CAT. REF.	
250	20		OU-VC0202-XX	25	25	OU-RP0212-XX	OU-RC0212-XX	
	35	OU-VP0352-XX	OU-VC0352-XX	50	50	OU-RP0512-XX	OU-RC0512-XX	
	50	OU-VP0502-XX	OU-VC0502-XX	50	75	OU-RP0522-XX	OU-RC0522-XX	
	80	OU-VP0802-XX	OU-VC0802-XX	50	100	OU-RP0532-XX	OU-RC0532-XX	
				75	75	OU-RP0712-XX	OU-RC0712-XX	
				75	100	OU-RP0722-XX	OU-RC0722-XX	
				75	125	OU-RP0732-XX	OU-RC0732-XX	
				75	150	OU-RP0742-XX	OU-RC0742-XX	
				100	100	OU-RP1012-XX	OU-RC1012-XX	
				100	150	OU-RP1022-XX	OU-RC1022-XX	
				100	200	OU-RP1032-XX	OU-RC1032-XX	
				100	230	OU-RP1042-XX	OU-RC1042-XX	
				125	125	OU-RP1212-XX	OU-RC1212-XX	
				125	275	OU-RP1222-XX	OU-RC1222-XX	

CODE X X	HARDNESS
80	80 SHORE A
90	90 SHORE A
95	95 SHORE A



***The Innovator of Our Industry <sup>SM</sup>***

Our factories and offices:

U.S.A. • U.K. • France • Belgium • Germany • Sweden • Netherlands • Singapore

**DANLY UK LIMITED**

Unit 1, Mucklow Hill 1 Trading Estate,  
Mucklow Hill, Halesowen,  
West Midlands, B62 8DF  
Tel: 0121 585 7171  
Fax: 0121 585 7272

**DANLY UK LIMITED**

2 Aintree Road  
Perivale, Middlesex  
UB6 7LA  
Tel: 0208 998 5381  
Fax: 0208 991 2461

E-mail: [sales@danlyuk.com](mailto:sales@danlyuk.com)  
Website: [www.danly.co.uk](http://www.danly.co.uk)

