



DANFLEX

RESSORTS
ET AUTRES PRODUITS
URETHANE



RESSORTS POUR CHARGE MOYENNE

DURETE : 80 SHORE A.

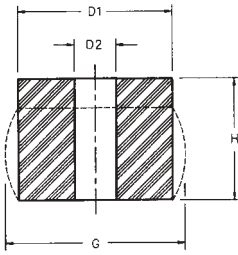

CODE COULEUR : BLEU

| D1 | D2 | H | NUMERO DE CATALOGUE | T A B L E A U D E S C H A R G E S D E D É F L E X I O N | | | | | | | | |
|-----|------|-----|---------------------|---|--------------|---------------|------------------------|--------------|---------------|-----------------------|--------------|---------------|
| | | | | Longue durée (25 %) | | | Durée moyenne (30 %) | | | Courte durée (35 %) | | |
| | | | | Charge da N | Déflexion mm | Gonflement mm | Charge da N | Déflexion mm | Gonflement mm | Charge da N | Déflexion mm | Gonflement mm |
| 16 | 6,5 | 13 | U-016013-80 | 48 | 3,3 | | 70 | 3,9 | | 94 | 4,6 | |
| | | 16 | U-016016-80 | 46 | 4,0 | | 65 | 4,8 | | 90 | 5,6 | |
| | | 20 | U-016020-80 | 46 | 5,0 | 20 | 62 | 6,0 | 21 | 88 | 7,0 | 22 |
| | | 25 | U-016025-80 | 43 | 6,3 | | 59 | 7,5 | | 86 | 8,8 | |
| 20 | 8,5 | 16 | U-020016-80 | 78 | 4,0 | | 102 | 4,8 | | 140 | 5,6 | |
| | | 20 | U-020020-80 | 73 | 5,0 | | 95 | 6,0 | | 135 | 7,0 | |
| | | 25 | U-020025-80 | 69 | 6,3 | 25 | 93 | 7,5 | 26 | 133 | 8,8 | 27 |
| | | 32 | U-020032-80 | 66 | 8,0 | | 87 | 9,6 | | 128 | 11,2 | |
| 25 | 10,5 | 20 | U-025020-80 | 113 | 5,0 | | 150 | 6,0 | | 220 | 7,0 | |
| | | 25 | U-025025-80 | 111 | 6,3 | | 148 | 7,5 | | 216 | 8,8 | |
| | | 32 | U-025032-80 | 110 | 8,0 | 31 | 146 | 9,6 | 33 | 209 | 11,2 | 34 |
| | | 40 | U-025040-80 | 108 | 10,0 | | 143 | 12,0 | | 205 | 14,0 | |
| 32 | 13,5 | 32 | U-032032-80 | 180 | 8,0 | | 242 | 9,6 | | 346 | 11,2 | |
| | | 40 | U-032040-80 | 178 | 10,0 | | 240 | 12,0 | | 342 | 14,0 | |
| | | 50 | U-032050-80 | 167 | 12,5 | 40 | 230 | 15,0 | 42 | 335 | 18,0 | 43 |
| | | 63 | U-032063-80 | 162 | 15,8 | | 220 | 18,9 | | 324 | 22,0 | |
| 40 | 13,5 | 32 | U-040032-80 | 320 | 8,0 | | 450 | 9,6 | | 619 | 11,2 | |
| | | 40 | U-040040-80 | 310 | 10,0 | | 420 | 12,0 | | 601 | 14,0 | |
| | | 50 | U-040050-80 | 305 | 12,5 | 50 | 400 | 15,0 | 52 | 587 | 18,0 | 54 |
| | | 63 | U-040063-80 | 280 | 15,8 | | 380 | 18,9 | | 576 | 22,0 | |
| 80 | 17 | 32 | U-050032-80 | 520 | 8,0 | | 700 | 9,6 | | 997 | 11,2 | |
| | | 40 | U-050040-80 | 490 | 10,0 | | 640 | 12,0 | | 965 | 14,0 | |
| | | 50 | U-050050-80 | 480 | 12,5 | 62 | 635 | 15,0 | 65 | 940 | 18,0 | 68 |
| | | 63 | U-050063-80 | 470 | 15,8 | | 630 | 18,9 | | 914 | 22,0 | |
| 50 | 17 | 80 | U-050080-80 | 465 | 20,0 | | 625 | 24,0 | | 898 | 28,0 | |
| | | 100 | U-050100-80 | 460 | 25,0 | | 620 | 30,0 | | 864 | 35,0 | |
| | | 32 | U-063032-80 | 980 | 8,0 | | 1200 | 9,6 | | 1760 | 11,2 | |
| | | 40 | U-063040-80 | 830 | 10,0 | | 1150 | 12,0 | | 1688 | 14,0 | |
| 63 | 17 | 50 | U-063050-80 | 820 | 12,5 | | 1100 | 15,0 | | 1631 | 18,0 | |
| | | 63 | U-063063-80 | 815 | 15,8 | 78 | 1070 | 18,9 | 82 | 1577 | 22,0 | 85 |
| | | 80 | U-063080-80 | 780 | 20,0 | | 1050 | 24,0 | | 1526 | 28,0 | |
| | | 100 | U-063100-80 | 770 | 25,0 | | 1030 | 30,0 | | 1494 | 35,0 | |
| 80 | 21 | 125 | U-063125-80 | 750 | 31,3 | | 1000 | 37,5 | | 1467 | 43,8 | |
| | | 32 | U-080032-80 | 1650 | 8,0 | | 2400 | 9,6 | | 2920 | 11,2 | |
| | | 40 | U-080040-80 | 1550 | 10,0 | | 2000 | 12,0 | | 2869 | 14,0 | |
| | | 50 | U-080050-80 | 1500 | 12,5 | | 1900 | 15,0 | | 2750 | 18,0 | |
| 100 | 21 | 63 | U-080063-80 | 1400 | 15,8 | 99 | 1850 | 18,9 | 104 | 2642 | 22,0 | 108 |
| | | 80 | U-080080-80 | 1350 | 20,0 | | 1800 | 24,0 | | 2556 | 28,0 | |
| | | 100 | U-080100-80 | 1300 | 25,0 | | 1750 | 30,0 | | 2481 | 35,0 | |
| | | 125 | U-080125-80 | 1250 | 31,3 | | 1700 | 37,5 | | 2419 | 43,8 | |
| 125 | 27 | 32 | U-100032-80 | 2800 | 8,0 | | 3500 | 9,6 | | 4960 | 11,2 | |
| | | 40 | U-100040-80 | 2500 | 10,0 | | 3300 | 12,0 | | 4800 | 14,0 | |
| | | 50 | U-100050-80 | 2400 | 12,5 | | 3250 | 15,0 | | 4673 | 18,0 | |
| | | 63 | U-100063-80 | 2300 | 15,8 | 124 | 3200 | 18,9 | 130 | 4457 | 22,0 | 135 |
| 150 | 27 | 80 | U-100080-80 | 2250 | 20,0 | | 3150 | 24,0 | | 4277 | 28,0 | |
| | | 100 | U-100100-80 | 2200 | 25,0 | | 2850 | 30,0 | | 4154 | 35,0 | |
| | | 125 | U-100125-80 | 2100 | 31,3 | | 2800 | 37,5 | | 3996 | 43,8 | |
| | | 32 | U-125032-80 | 4800 | 8,0 | | 5600 | 9,6 | | 8900 | 11,2 | |
| 169 | 27 | 40 | U-125040-80 | 4500 | 10,0 | | 5500 | 12,0 | | 8400 | 14,0 | |
| | | 50 | U-125050-80 | 4100 | 12,5 | | 5300 | 15,0 | | 7900 | 18,0 | |
| | | 63 | U-125063-80 | 3900 | 15,8 | 155 | 5100 | 18,9 | 163 | 7395 | 22,0 | 169 |
| | | 80 | U-125080-80 | 3700 | 20,0 | | 5000 | 24,0 | | 6948 | 28,0 | |
| 150 | 27 | 100 | U-125100-80 | 3550 | 25,0 | | 4800 | 30,0 | | 6610 | 35,0 | |
| | | 125 | U-125125-80 | 3300 | 31,3 | | 4700 | 37,5 | | 6476 | 43,8 | |
| | | 150 | U-125150-80 | 3250 | 37,5 | | 4300 | 45,0 | | 5500 | 52,5 | |

RESSORTS POUR CHARGE FORTE

DURETE : 90 SHORE A.

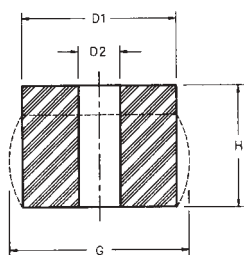

CODE COULEUR : ROUGE

| D1 | D2 | H | NUMERO DE CATALOGUE | T A B L E A U D E S C H A R G E S D E D E F L E X I O N | | | | | | | | |
|-----|------|-----|---------------------|---|--------------|---------------|----------------------|--------------|---------------|---------------------|--------------|---------------|
| | | | | Longue durée (20 %) | | | Durée moyenne (25 %) | | | Courte durée (30 %) | | |
| | | | | Charge da N | Déflexion mm | Gonflement mm | Charge da N | Déflexion mm | Gonflement mm | Charge da N | Déflexion mm | Gonflement mm |
| 16 | 6,5 | 13 | U-016013-90 | 102 | 2,6 | 19 | 128 | 3,3 | 20 | 178 | 3,9 | 21 |
| | | 16 | U-016016-90 | 90 | 3,2 | | 122 | 4,0 | | 173 | 4,8 | |
| | | 20 | U-016020-90 | 88 | 4,0 | | 120 | 5,0 | | 169 | 6,0 | |
| | | 25 | U-016025-90 | 86 | 5,0 | | 117 | 6,3 | | 166 | 7,5 | |
| 20 | 8,5 | 16 | U-020016-90 | 136 | 3,2 | 24 | 185 | 4,0 | 25 | 269 | 4,8 | 26 |
| | | 20 | U-020020-90 | 134 | 4,0 | | 182 | 5,0 | | 259 | 6,0 | |
| | | 25 | U-020025-90 | 132 | 5,0 | | 180 | 6,3 | | 255 | 7,5 | |
| | | 32 | U-020032-90 | 128 | 6,4 | | 178 | 8,0 | | 245 | 9,6 | |
| 25 | 10,5 | 20 | U-025020-90 | 220 | 4,0 | 30 | 300 | 5,0 | 31 | 421 | 6,0 | 33 |
| | | 25 | U-025025-90 | 217 | 5,0 | | 285 | 6,3 | | 414 | 7,5 | |
| | | 32 | U-025032-90 | 212 | 6,4 | | 278 | 8,0 | | 400 | 9,6 | |
| | | 40 | U-025040-90 | 208 | 8,0 | | 276 | 10,0 | | 393 | 12,0 | |
| 32 | 13,5 | 32 | U-032032-90 | 340 | 6,4 | 39 | 465 | 8,0 | 40 | 662 | 9,6 | 42 |
| | | 40 | U-032040-90 | 330 | 8,0 | | 460 | 10,0 | | 656 | 12,0 | |
| | | 50 | U-032050-90 | 325 | 10,0 | | 450 | 12,5 | | 642 | 15,0 | |
| | | 63 | U-032063-90 | 310 | 12,5 | | 440 | 15,8 | | 621 | 18,9 | |
| 40 | 13,5 | 32 | U-040032-90 | 630 | 6,4 | 48 | 830 | 8,0 | 50 | 1187 | 9,6 | 52 |
| | | 40 | U-040040-90 | 605 | 8,0 | | 820 | 10,0 | | 1152 | 12,0 | |
| | | 50 | U-040050-90 | 595 | 10,0 | | 800 | 12,5 | | 1125 | 15,0 | |
| | | 63 | U-040063-90 | 580 | 12,5 | | 790 | 15,8 | | 1104 | 18,9 | |
| 50 | 17 | 32 | U-050032-90 | 1000 | 6,4 | 60 | 1350 | 8,0 | 62 | 1911 | 9,6 | 65 |
| | | 40 | U-050040-90 | 990 | 8,0 | | 1310 | 10,0 | | 1849 | 12,0 | |
| | | 50 | U-050050-90 | 950 | 10,0 | | 1250 | 12,5 | | 1801 | 15,0 | |
| | | 63 | U-050063-90 | 930 | 12,5 | | 1240 | 15,8 | | 1753 | 18,9 | |
| 80 | 21 | 32 | U-080032-90 | 3500 | 6,4 | 95 | 4200 | 8,0 | 99 | 5750 | 9,6 | 104 |
| | | 40 | U-080040-90 | 3300 | 8,0 | | 4000 | 10,0 | | 5500 | 12,0 | |
| | | 50 | U-080050-90 | 2700 | 10,0 | | 3800 | 12,5 | | 5272 | 15,0 | |
| | | 63 | U-080063-90 | 2600 | 12,5 | | 3600 | 15,8 | | 5065 | 18,9 | |
| 100 | 21 | 32 | U-100032-90 | 5500 | 6,4 | 119 | 7800 | 8,0 | 124 | 9942 | 9,6 | 130 |
| | | 40 | U-100040-90 | 5200 | 8,0 | | 7100 | 10,0 | | 9527 | 12,0 | |
| | | 50 | U-100050-90 | 4800 | 10,0 | | 6500 | 12,5 | | 8956 | 15,0 | |
| | | 63 | U-100063-90 | 4500 | 12,5 | | 6200 | 15,8 | | 8542 | 18,9 | |
| 125 | 27 | 32 | U-125032-90 | 11000 | 6,4 | 149 | 14000 | 8,0 | 155 | 16875 | 9,6 | 163 |
| | | 40 | U-125040-90 | 10000 | 8,0 | | 13000 | 10,0 | | 16367 | 12,0 | |
| | | 50 | U-125050-90 | 9000 | 10,0 | | 11000 | 12,5 | | 15223 | 15,0 | |
| | | 63 | U-125063-90 | 7500 | 12,5 | | 10500 | 15,8 | | 14163 | 18,9 | |
| 150 | 27 | 80 | U-125080-90 | 7200 | 16,0 | 155 | 10000 | 20,0 | 155 | 13317 | 24,0 | 163 |
| | | 100 | U-125100-90 | 6750 | 20,0 | | 9100 | 25,0 | | 12668 | 30,0 | |
| | | 125 | U-125125-90 | 6600 | 25,0 | | 8600 | 31,3 | | 12413 | 37,5 | |
| | | 150 | U-125150-90 | 6200 | 30,0 | | 8400 | 37,5 | | 11937 | 45,0 | |

RESSORTS POUR CHARGE EXTRA FORTE

DURETE : 95 SHORE A.

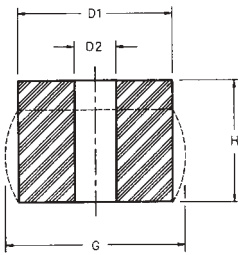

CODE COULEUR : JAUNE

| D1 | D2 | H | NUMERO DE CATALOGUE | T A B L E A U D E S C H A R G E S D E D É F L E X I O N | | | | | | | | |
|-----|-------------|------|---------------------|---|--------------|---------------|----------------------|--------------|---------------|---------------------|--------------|---------------|
| | | | | Longue durée (15 %) | | | Durée moyenne (20 %) | | | Courte durée (25 %) | | |
| | | | | Charge da N | Déflexion mm | Gonflement mm | Charge da N | Déflexion mm | Gonflement mm | Charge da N | Déflexion mm | Gonflement mm |
| 16 | 6,5 | 13 | U-016013-95 | 102 | 2,0 | | 158 | 2,6 | | 222 | 3,3 | 20 |
| | | 16 | U-016016-95 | 99 | 2,4 | | 142 | 3,2 | | 217 | 4,0 | |
| | | 20 | U-016020-95 | 97 | 3,0 | 18 | 141 | 4,0 | 19 | 213 | 5,0 | |
| | | 25 | U-016025-95 | 95 | 3,8 | | 136 | 5,0 | | 208 | 6,3 | |
| 20 | 8,5 | 16 | U-020016-95 | 155 | 2,4 | | 220 | 3,2 | | 339 | 4,0 | 25 |
| | | 20 | U-020020-95 | 150 | 3,0 | | 215 | 4,0 | | 326 | 5,0 | |
| | | 25 | U-020025-95 | 145 | 3,8 | 23 | 208 | 5,0 | 24 | 321 | 6,3 | |
| | | 32 | U-020032-95 | 142 | 4,8 | | 203 | 6,4 | | 308 | 8,0 | |
| 25 | 10,5 | 20 | U-025020-95 | 240 | 3,0 | | 350 | 4,0 | | 529 | 5,0 | 31 |
| | | 25 | U-025025-95 | 235 | 3,8 | | 345 | 5,0 | | 521 | 6,3 | |
| | | 32 | U-025032-95 | 230 | 4,8 | 29 | 340 | 6,4 | 30 | 503 | 8,0 | |
| | | 40 | U-025040-95 | 225 | 6,0 | | 330 | 8,0 | | 495 | 10,0 | |
| 32 | 13,5 | 32 | U-032032-95 | 380 | 4,8 | | 570 | 6,4 | | 833 | 8,0 | 40 |
| | | 40 | U-032040-95 | 375 | 6,0 | | 550 | 8,0 | | 825 | 10,0 | |
| | | 50 | U-032050-95 | 370 | 7,5 | 37 | 530 | 10,0 | 39 | 807 | 12,5 | |
| | | 63 | U-032063-95 | 355 | 9,5 | | 510 | 12,5 | | 781 | 15,8 | |
| 40 | 13,5 | 32 | U-040032-95 | 700 | 4,8 | | 970 | 6,4 | | 1493 | 8,0 | 50 |
| | | 40 | U-040040-95 | 660 | 6,0 | | 960 | 8,0 | | 1450 | 10,0 | |
| | | 50 | U-040050-95 | 630 | 7,5 | 46 | 950 | 10,0 | 48 | 1415 | 12,5 | |
| | | 63 | U-040063-95 | 620 | 9,5 | | 910 | 12,5 | | 1389 | 15,8 | |
| 80 | U-040080-95 | 600 | 12,0 | | 880 | 16,0 | | 1337 | 20,0 | | | |
| 50 | 17 | 32 | U-050032-95 | 1100 | 4,8 | | 1550 | 6,4 | | 2404 | 8,0 | 62 |
| | | 40 | U-050040-95 | 1060 | 6,0 | | 1530 | 8,0 | | 2326 | 10,0 | |
| | | 50 | U-050050-95 | 1050 | 7,5 | 57 | 1510 | 10,0 | 60 | 2265 | 12,5 | |
| | | 63 | U-050063-95 | 1040 | 9,5 | | 1500 | 12,5 | | 2205 | 15,8 | |
| | | 80 | U-050080-95 | 1020 | 12,0 | | 1490 | 16,0 | | 2166 | 20,0 | |
| | | 100 | U-050100-95 | 1010 | 15,0 | | 1470 | 20,0 | | 2083 | 25,0 | |
| 63 | 17 | 32 | U-063032-95 | 2150 | 4,8 | | 2950 | 6,4 | | 4245 | 8,0 | 78 |
| | | 40 | U-063040-95 | 2100 | 6,0 | | 2850 | 8,0 | | 4071 | 10,0 | |
| | | 50 | U-063050-95 | 1800 | 7,5 | 72 | 2700 | 10,0 | 75 | 3932 | 12,5 | |
| | | 63 | U-063063-95 | 1780 | 9,5 | | 2650 | 12,5 | | 3802 | 15,8 | |
| | | 80 | U-063080-95 | 1750 | 12,0 | | 2500 | 16,0 | | 3680 | 20,0 | |
| | | 100 | U-063100-95 | 1700 | 15,0 | | 2400 | 20,0 | | 3602 | 25,0 | |
| 125 | U-063125-95 | 1650 | 18,8 | | 2300 | 25,0 | | 3537 | 31,3 | | | |
| 80 | 21 | 32 | U-080032-95 | 3100 | 4,8 | | 4600 | 6,4 | | 7231 | 8,0 | 99 |
| | | 40 | U-080040-95 | 3000 | 6,0 | | 4400 | 8,0 | | 6918 | 10,0 | |
| | | 50 | U-080050-95 | 2950 | 7,5 | 91 | 4200 | 10,0 | 95 | 6632 | 12,5 | |
| | | 63 | U-080063-95 | 2900 | 9,5 | | 4100 | 12,5 | | 6371 | 15,8 | |
| | | 80 | U-080080-95 | 2800 | 12,0 | | 4050 | 16,0 | | 6163 | 20,0 | |
| | | 100 | U-080100-95 | 2750 | 15,0 | | 4000 | 20,0 | | 6007 | 25,0 | |
| 125 | U-080125-95 | 2700 | 18,8 | | 3800 | 25,0 | | 5833 | 31,3 | | | |
| 100 | 21 | 32 | U-100032-95 | 5700 | 4,8 | | 7600 | 6,4 | | 12879 | 8,0 | 124 |
| | | 40 | U-100040-95 | 5500 | 6,0 | | 7400 | 8,0 | | 12035 | 10,0 | |
| | | 50 | U-100050-95 | 5300 | 7,5 | 114 | 7200 | 10,0 | 119 | 11267 | 12,5 | |
| | | 63 | U-100063-95 | 4800 | 9,5 | | 7100 | 12,5 | | 10746 | 15,8 | |
| | | 80 | U-100080-95 | 4700 | 12,0 | | 7000 | 16,0 | | 10312 | 20,0 | |
| | | 100 | U-100100-95 | 4600 | 15,0 | | 6800 | 20,0 | | 10017 | 25,0 | |
| 125 | U-100125-95 | 4500 | 18,8 | | 6500 | 25,0 | | 9635 | 31,3 | | | |
| 125 | 27 | 32 | U-125032-95 | 8900 | 4,8 | | 14500 | 6,4 | | 21654 | 8,0 | 155 |
| | | 40 | U-125040-95 | 8500 | 6,0 | | 13800 | 8,0 | | 20234 | 10,0 | |
| | | 50 | U-125050-95 | 8300 | 7,5 | 143 | 13400 | 10,0 | 149 | 18976 | 12,5 | |
| | | 63 | U-125063-95 | 8000 | 9,5 | | 12300 | 12,5 | | 17829 | 15,8 | |
| | | 80 | U-125080-95 | 7800 | 12,0 | | 11000 | 16,0 | | 16752 | 20,0 | |
| | | 100 | U-125100-95 | 7500 | 15,0 | | 10800 | 20,0 | | 15936 | 25,0 | |
| | | 125 | U-125125-95 | 7300 | 18,8 | | 10600 | 25,0 | | 15615 | 31,3 | |
| | | 150 | U-125150-95 | 7200 | 22,5 | | 10000 | 30,0 | | 15016 | 38,0 | |

Matière : Polyamide.

L'empilage des ressorts réduit leur gonflement, augmente leur charge totale et permet une augmentation significative de leur longévité.

RONDELLES INTERCALAIRES

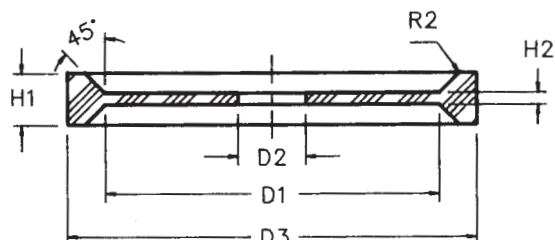

RONDELLES D'EXTREMITÉ

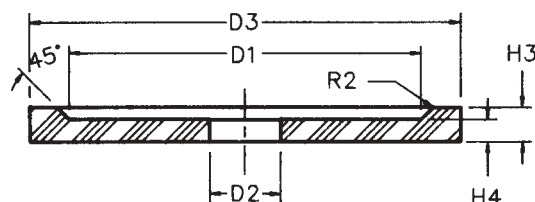

| NUMERO DE CATALOGUE | D1 ± 0,5 mm | D2 H 11 mm | D3 ± 0,3 mm | H1 ± 0,5 mm | H2 ± 0,5 mm |
|---------------------|-------------|------------|-------------|-------------|-------------|
| U-RIM016 | 16,5 | 6,5 | 24 | 4,5 | 1,3 |
| U-RIM020 | 20,5 | 8,5 | 30 | 5,6 | 1,6 |
| U-RIM025 | 25,5 | 10,5 | 34 | 6,3 | 2,0 |
| U-RIM032 | 33,0 | 13,5 | 45 | 7,1 | 2,0 |
| U-RIM040 | 41,0 | 13,5 | 54 | 8,0 | 2,5 |
| U-RIM050 | 51,0 | 16,5 | 66 | 10,0 | 2,5 |
| U-RIM063 | 64,0 | 16,5 | 80 | 10,0 | 3,2 |
| U-RIM080 | 82,0 | 20,5 | 100 | 13,0 | 3,2 |
| U-RIM100 | 102,0 | 20,5 | 125 | 16,0 | 3,6 |
| U-RIM125 | 128,0 | 20,5 | 150 | 16,0 | 3,6 |

| NUMERO DE CATALOGUE | D1 ± 0,5 mm | D2 H 11 mm | D3 ± 0,3 mm | H3 ± 0,5 mm | H4 ± 0,5 mm |
|---------------------|-------------|------------|-------------|-------------|-------------|
| U-RIB016 | 16,5 | 6,5 | 24 | 3,8 | 1,8 |
| U-RIB020 | 20,5 | 8,5 | 30 | 4,2 | 2,2 |
| U-RIB025 | 25,5 | 10,5 | 34 | 4,8 | 2,4 |
| U-RIB032 | 33,0 | 13,5 | 45 | 5,0 | 2,7 |
| U-RIB040 | 41,0 | 13,5 | 54 | 5,8 | 3,0 |
| U-RIB050 | 51,0 | 16,5 | 66 | 6,5 | 3,5 |
| U-RIB063 | 64,0 | 16,5 | 80 | 7,5 | 4,0 |
| U-RIB080 | 82,0 | 20,5 | 100 | 8,5 | 5,0 |
| U-RIB100 | 102,0 | 20,5 | 125 | 10,0 | 6,5 |
| U-RIB125 | 128,0 | 20,5 | 150 | 10,0 | 6,5 |

COEFFICIENT D'AUGMENTATION DE CHARGE PAR EMPILAGE DES RESSORTS

| DIAMETRE EXTERIEUR | NOMBRE DE RESSORTS EMPILÉS | | |
|--------------------|----------------------------|------|------|
| | 2 | 3 | 4 |
| 16 | 1,04 | - | - |
| 20 | 1,05 | - | - |
| 25 | 1,06 | - | - |
| 32 | 1,07 | - | - |
| 40 | 1,08 | - | - |
| 50 | 1,09 | 1,12 | - |
| 63 | 1,10 | 1,15 | 1,18 |
| 80 | 1,13 | 1,17 | 1,20 |
| 100 | 1,15 | 1,20 | 1,23 |
| 125 | 1,18 | 1,22 | 1,25 |

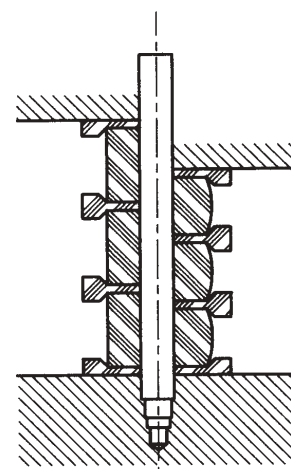

EXEMPLE :

Un ressort U-063100-90 soumis à une déflexion de 25 mm a une charge de 1950 daN.

Un empilage de 2 ressorts U-063050-90 soumis à la même déflexion totale de 25 mm, aura une charge totale de $1950 \times 1,10 = 2145$ daN.

DEVETISSEURS

DURETE : 90 SHORE A.



| NUMERO DE CATALOGUE | D1 mm | D2 mm | H mm | B mm |
|---------------------|-------|-------|------|------|
| U-ST0456 | 16 | 4 | 56 | 1,6 |
| U-ST0556 | 18 | 5 | 56 | 1,6 |
| U-ST0656 | 19 | 6 | 56 | 1,6 |
| U-ST0665 | 19 | 6 | 65 | 1,6 |
| U-ST0856 | 21 | 8 | 56 | 1,6 |
| U-ST0875 | 21 | 8 | 75 | 1,6 |
| U-ST1056 | 23 | 10 | 56 | 2,5 |
| U-ST1075 | 23 | 10 | 75 | 2,5 |
| U-ST1356 | 26 | 13 | 56 | 3,0 |
| U-ST1375 | 26 | 13 | 75 | 3,0 |
| U-ST1656 | 30 | 16 | 56 | 3,0 |
| U-ST1675 | 30 | 16 | 75 | 3,0 |
| U-ST2056 | 38 | 20 | 56 | 3,0 |
| U-ST2556 | 50 | 25 | 56 | 3,0 |
| U-ST3256 | 63 | 32 | 56 | 3,0 |
| U-ST3556 | 65 | 35 | 56 | 3,0 |
| U-ST5056 | 80 | 50 | 56 | 3,0 |

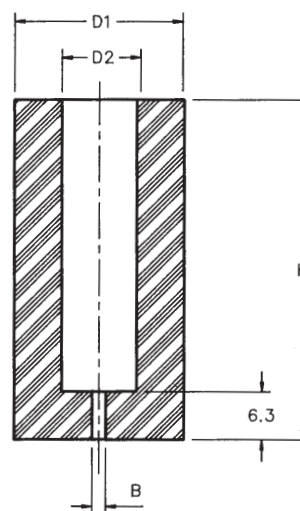

Autres duretés et longueurs disponibles sur demande.

JETS CREUX

| D1 mm | D2 mm | N° CAT. H = 250 mm | N° CAT. H = 500 mm | D1 mm | D2 mm | N° CAT. H = 250 mm | N° CAT. H = 500 mm |
|-------|-------|--------------------|--------------------|-------|-------|--------------------|--------------------|
| 16 | 6,5 | U-016250-XX | U-016500-XX | 50 | 17 | U-050250-XX | U-050500-XX |
| 20 | 8,5 | U-020250-XX | U-020500-XX | 63 | 17 | U-063250-XX | U-063500-XX |
| 25 | 10,5 | U-025250-XX | U-025500-XX | 80 | 21 | U-080250-XX | U-080500-XX |
| 32 | 13,5 | U-032250-XX | U-032500-XX | 100 | 21 | U-100250-XX | U-100500-XX |
| 40 | 13,5 | U-040250-XX | U-040500-XX | 125 | 27 | U-125250-XX | U-125500-XX |

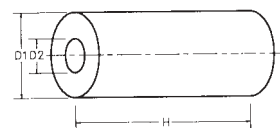

| CODE X X | DURETÉ | COULEUR |
|----------|------------|---------|
| 80 | 80 SHORE A | BLEU |
| 90 | 90 SHORE A | ROUGE |
| 95 | 95 SHORE A | JAUNE |

JETS PLEINS

| D | H | | D | H | | D | H |
|----|--------|--------|-----|--------|--------|-----|--------|
| | 250 mm | 500 mm | | 250 mm | 500 mm | | 250 mm |
| 2 | • | | 63 | • | • | 175 | • |
| 3 | • | | 65 | • | • | 180 | • |
| 4 | • | | 70 | • | • | 190 | • |
| 5 | • | | 75 | • | • | 200 | • |
| 6 | • | | 80 | • | • | 200 | • |
| 7 | • | | 85 | • | • | 205 | • |
| 8 | • | • | 90 | • | • | 210 | • |
| 10 | • | • | 95 | • | | 220 | • |
| 12 | • | • | 100 | • | • | 225 | • |
| 13 | • | • | 104 | • | | 230 | • |
| 14 | • | • | 108 | • | | 230 | • |
| 15 | • | • | 110 | • | • | 255 | • |
| 16 | • | • | 115 | • | | 260 | • |
| 18 | • | • | 120 | • | | 270 | • |
| 20 | • | • | 125 | • | • | 280 | • |
| 25 | • | • | 129 | • | | 285 | • |
| 30 | • | • | 130 | • | | 300 | • |
| 32 | • | • | 135 | • | | 310 | • |
| 35 | • | • | 140 | • | | 320 | • |
| 40 | • | • | 145 | • | | 330 | • |
| 45 | • | • | 150 | • | | 350 | • |
| 50 | • | • | 155 | • | | 380 | • |
| 55 | • | • | 160 | • | | 400 | • |
| 60 | • | • | 170 | • | | | |

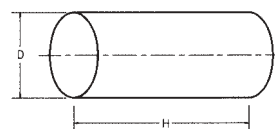

DÉTERMINEZ LE N° DE CATALOGUE SUIVANT CES EXEMPLES :

Exemples de commande :

Jet plein 80 SHORE A, D = 32 mm,
H = 500 mm
N° catalogue : **U-PT0325-80**

Jet plein 95 SHORE A, D = 210 mm,
H = 250 mm
N° catalogue : **U-PT2102-95**

| S mm | NUMERO DE CATALOGUE | | | | |
|---------|--------------------------|--------------------------|--------------------------|---------------------------|----------------------------|
| | A = 250 mm B = 250 mm | A = 500 mm B = 250 mm | A = 500 mm B = 500 mm | A = 1000 mm B = 500 mm | A = 1000 mm B = 1000 mm |
| 0,5 | U-P1005-XX | - | - | - | - |
| 1,0 | U-P1010-XX | U-P2010-XX | U-P3010-XX | U-P4010-XX | - |
| 1,5 | U-P1015-XX | U-P2015-XX | U-P3015-XX | U-P4015-XX | - |
| 2,0 | U-P1020-XX | U-P2020-XX | U-P3020-XX | U-P4020-XX | - |
| 3,0 | U-P1030-XX | U-P2030-XX | U-P3030-XX | U-P4030-XX | - |
| 4,0 | U-P1040-XX | U-P2040-XX | U-P3040-XX | U-P4040-XX | U-P5040-XX |
| 5,0 | U-P1050-XX | U-P2050-XX | U-P3050-XX | U-P4050-XX | U-P5050-XX |
| 6,0 | U-P1060-XX | U-P2060-XX | U-P3060-XX | U-P4060-XX | U-P5060-XX |
| 7,0 | U-P1070-XX | U-P2070-XX | U-P3070-XX | U-P4070-XX | U-P5070-XX |
| 8,0 | U-P1080-XX | U-P2080-XX | U-P3080-XX | U-P4080-XX | U-P5080-XX |
| 9,0 | U-P1090-XX | U-P2090-XX | U-P3090-XX | U-P4090-XX | U-P5090-XX |
| 10,0 | U-P1100-XX | U-P2100-XX | U-P3100-XX | U-P4100-XX | U-P5100-XX |
| 12,0 | U-P1120-XX | U-P2120-XX | U-P3120-XX | U-P4120-XX | U-P5120-XX |
| 15,0 | U-P1150-XX | U-P2150-XX | U-P3150-XX | U-P4150-XX | U-P5150-XX |
| 18,0 | U-P1180-XX | U-P2180-XX | U-P3180-XX | U-P4180-XX | U-P5180-XX |
| 20,0 | U-P1200-XX | U-P2200-XX | U-P3200-XX | U-P4200-XX | U-P5200-XX |
| 25,0 | U-P1250-XX | U-P2250-XX | U-P3250-XX | U-P4250-XX | U-P5250-XX |
| 30,0 | U-P1300-XX | U-P2300-XX | U-P3300-XX | U-P4300-XX | U-P5300-XX |
| 35,0 | U-P1350-XX | U-P2350-XX | U-P3350-XX | U-P4350-XX | U-P5350-XX |
| 40,0 | U-P1400-XX | U-P2400-XX | U-P3400-XX | U-P4400-XX | U-P5400-XX |
| 45,0 | U-P1450-XX | U-P2450-XX | U-P3450-XX | U-P4450-XX | U-P5450-XX |
| 50,0 | U-P1500-XX | U-P2500-XX | U-P3500-XX | U-P4500-XX | U-P5500-XX |
| 55,0 | U-P1550-XX | U-P2550-XX | U-P3550-XX | U-P4550-XX | U-P5550-XX |
| 60,0 | U-P1600-XX | U-P2600-XX | U-P3600-XX | U-P4600-XX | U-P5600-XX |
| 65,0 | U-P1650-XX | U-P2650-XX | U-P3650-XX | U-P4650-XX | U-P5650-XX |
| 70,0 | U-P1700-XX | U-P2700-XX | U-P3700-XX | U-P4700-XX | U-P5700-XX |
| 75,0 | U-P1750-XX | U-P2750-XX | U-P3750-XX | U-P4750-XX | U-P5750-XX |
| 80,0 | U-P1800-XX | U-P2800-XX | U-P3800-XX | U-P4800-XX | U-P5800-XX |

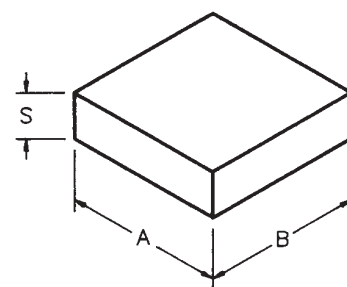

| CODE X X | DURETÉ | COULEUR |
|----------|------------|---------|
| 80 | 80 SHORE A | BLEU |
| 90 | 90 SHORE A | ROUGE |
| 95 | 95 SHORE A | JAUNE |

COUSSINS

| L mm | SECTION TRIANGULAIRE | | | | SECTION RECTANGULAIRE / CARRÉE | | | |
|--------------|----------------------|--------------|--------------|---------|--------------------------------|-------------|-------------|--|
| | B mm | PLEINE | CREUSE | A mm | B mm | PLEINE | CREUSE | |
| | | | | | | | | |
| N° CATALOGUE | N° CATALOGUE | N° CATALOGUE | N° CATALOGUE | | | | | |
| 250 | 20 | | U-VC0202-XX | 25 | 25 | U-RP0212-XX | U-RC0212-XX | |
| | 35 | U-VP0352-XX | U-VC0352-XX | 50 | 50 | U-RP0512-XX | U-RC0512-XX | |
| | 50 | U-VP0502-XX | U-VC0502-XX | 50 | 75 | U-RP0522-XX | U-RC0522-XX | |
| | 80 | U-VP0802-XX | U-VC0802-XX | 50 | 100 | U-RP0532-XX | U-RC0532-XX | |
| | | | | 75 | 75 | U-RP0712-XX | U-RC0712-XX | |
| | | | | 75 | 100 | U-RP0722-XX | U-RC0722-XX | |
| | | | | 75 | 125 | U-RP0732-XX | U-RC0732-XX | |
| | | | | 75 | 150 | U-RP0742-XX | U-RC0742-XX | |
| | | | | 100 | 100 | U-RP1012-XX | U-RC1012-XX | |
| | | | | 100 | 150 | U-RP1022-XX | U-RC1022-XX | |
| | | | | 100 | 200 | U-RP1032-XX | U-RC1032-XX | |
| | | | | 100 | 230 | U-RP1042-XX | U-RC1042-XX | |
| | | | | 125 | 125 | U-RP1212-XX | U-RC1212-XX | |
| | | | | 125 | 275 | U-RP1222-XX | U-RC1222-XX | |

| CODE X X | DURETÉ | COULEUR |
|----------|------------|---------|
| 80 | 80 SHORE A | BLEU |
| 90 | 90 SHORE A | ROUGE |
| 95 | 95 SHORE A | JAUNE |



Tous nos produits sont disponibles dans le monde

Nos usines et bureaux :

U.S.A. • Royaume-Uni • France • Belgique • Allemagne • Suède • Pays-Bas • Singapour

DANLY FRANCE

Z.I. Route de Crouy - BP 23
F-60531 Neuilly-en-Thelle Cedex
Tél. + 33 (0)3 44 26 53 53
Fax + 33 (0)3 44 26 87 87
E-mail : danly-nop@danly.fr

DANLY EUROP

Parc Industriel des Hauts Sarts
B-4040 Herstal
Tél. + 32 (0)4 256 96 50
Fax + 32 (0)4 256 96 59
E-mail : danlyeurop.sales@danly.be

